

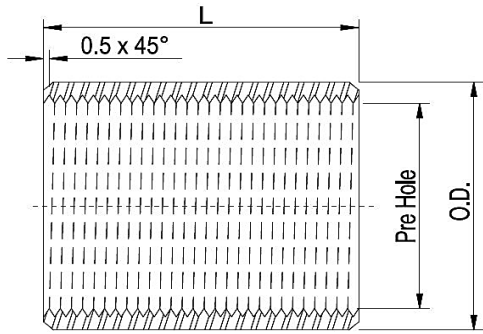

**STAINLESS STEEL
150 LBS SCREWED FITTINGS
BSPP (ISO 228-1), BSPT (ISO 7-1), NPT THREAD**

DIMENSION CONFORM TO DIN 2986
MATERIAL CONFORM TO ASTM A351 GR. CF8 & CF8M
PRESSURE-TEMPERATURE RATINGS 300 PSI (-29 TO 66°C)
MADE BY LOST WAX INVESTMENT CASTING



COUPLING DIN 2986

SIZE	O.D. (mm)	Pre-Hole (mm)	L (mm)	Weight (Kg/Pc)
1/8"	15.0	8.7	17.0	0.016
1/4"	18.5	11.8	25.0	0.032
3/8"	21.3	15.2	26.0	0.036
1/2"	26.4	19.0	34.0	0.072
3/4"	31.8	24.5	36.0	0.093
1"	39.5	30.7	43.0	0.166
1 1/4"	49.3	39.5	48.0	0.262
1 1/2"	55.5	45.2	48.0	0.312
2"	69.0	57.0	56.0	0.530
2 1/2"	87.0	72.5	65.0	0.942
3"	100.0	85.2	71.0	1.219
4"	126.0	110.5	83.0	1.906
5"	147.0	135.4	92.0	1.888
6"	174.0	160.8	92.0	2.547